

## Clevis Safety Hook Pewag KLHW

---

### Product information



KLHW Clevis safety hooks are designed for the assembly of chain slings. Closes and locks automatically.

... [Read more](#)

---

**Material:** High duty grade 10.

**Marking:** According to standard, CE-marked, Pewag or PW, winner or 10, H16, batch code and type.

**Temperature range:** -40°C up to +380°C.

**Finish:** Orange powder coated.

**Standard:** EN 1677-3

**Safety factor:** 4:1

**Grade:** 10

## Clevis Safety Hook Pewag KLHW

### Blueprint

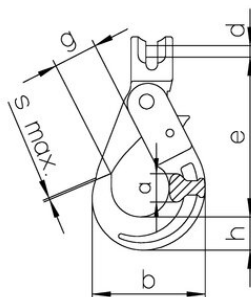

### Technical data

Part code	Code	WLL ton	EWL	a mm	b mm mm	d mm mm	e mm mm	g mm mm	h mm mm	s max. mm mm	Weight kg
402300140480	KLHW 5/6	1.4	94	17	71	7.4	94	28	20	1	0.56
402300190480	KLHW 7	1.9	123	20	88	9	123	34	26	1	0.87
402300250480	KLHW 8	2.5	123	20	88	10	123	34	26	1	1
402300400480	KLHW 10	4	144	29	107	12.5	144	45	30	1	1.61
402300670480	KLHW 13	6.7	180	35	138	16	180	52	40	1.5	3.25
402301000480	KLHW 16	10	218	41	168	20	218	60	50	2	5.95
402301600480	KLHW 19/20	16	259	50	194	24	259	70	62	2	12.89
402301900480	KLHW 22	19	286	52	211	27	286	81	65	2	15.91
402302650480	KLHW 26	26.5	338	61	253	33	338	100	79	2	21.33