

## Safety Hook Pewag LHW

---

### Product information



LHW Safety hooks are designed for the assembly of pewag connex system. This hook has a large eye, which is suitable for ropes and webbing slings. Automatically closes and locks under load and requires the load to be grounded before load can be released

#### Features:

- Self-closing and locking load hook
- Larger jaw opening than the HSW
- Locking set is available as a spare part

... [Read more](#)

---

**Marking:** According to standard, CE-marked

**Temperature range:** -40°C up to +380°C.

**Finish:** Orange powder coated.

**Standard:** EN 1677-3

**Note:** Not for welded system!

**Safety factor:** 4:1

**Grade:** 10

## Safety Hook Pewag LHW

### Blueprint

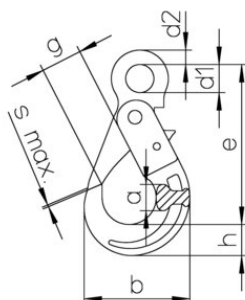

### Technical data

Part code	Code	WLL ton	EWL	a mm	b mm	d1 mm	d2 mm	e mm	g mm	h mm	s max. mm	Weight kg
402300140460	LHW 5/6	1.4	110	17	71	21	11	110	28	20	1	0.53
402300250460	LHW 7/8	2.5	136	20	88	25	12	136	34	26	1	0.92
402300400460	LHW 10	4	169	29	107	35	15	169	45	30	1	1.57
402300670460	LHW 13	6.7	205	41	138	40	20	205	52	40	1.5	3.19
402301000460	LHW 16	10	251	50	168	50	27	251	60	50	2	6.24
402301600460	LHW 19/20	16	290	52	194	60	30	290	70	62	2	9.75
402301900460	LHW 22	19	322	61	211	70	32	322	81	65	2	12.45
402302650460	LHW 26	26.5	-	61	253	82	42	383	100	79	2	20