

## Connecting Link V/S Grade 10

### Product information



Connecting link for: masterlink - chain, chain - chain, (eye)hook - chain

... [Read more](#)

**Material:** Alloy steel.

**Marking:** According to standard, CE-marked

**Temperature range:** -40°C up to 380°C

**Finish:** Violet powder coated.

**Standard:** EN 1677-1 (+ 25% WLL)

**Note:** Not to be heat-treated.

**Warning:** For straight in-line pull only. Not to be heat-treated.

**Safety factor:** 4:1

**Grade:** 10

## Connecting Link V/S Grade 10

### Blueprint

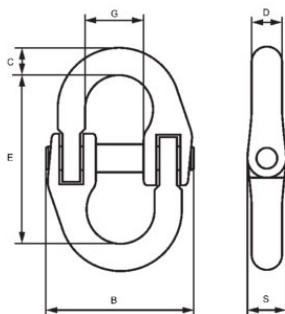

### Technical data

Part code	Code	WLL ton	For chain Ø mm	B mm	C mm	D, mm	E mm	G, mm	S mm	Weight kg
402200140100	V/S 6	1.4	6	39	8	8	44	14	11	0.11
402200190100	V/S 7	1.9	7	47	10	9	51	17	13	0.2
402200250100	V/S 8	2.5	8	55	12	10	62	18	14	0.29
402200400100	V/S 10	4	10	64	15	13	72	24	18	0.52
402200670100	V/S 13	6.7	13	79	20	17	88	28	22	0.91
402201000100	V/S 16	10	16	106	21	21	103	33	29	1.34
402201600100	V/S 19/20	16	19-20	123	30	24	115	42	35	3.33
402201900100	V/S 22	19	22	148	34	25	161	51	39	3.14
402202650100	V/S 26	26.5	26	175	40	30	190	60	46	5.72