

Open Wedge Socket OWS B with Bolt

Product information



Intended for attaching of wire rope where switching often occur, e.g. blocks of mobilecranes, or to be able to adjust the length of the wire rope. See recommended assembly to get correct results.

The wedge socket is delivered complete with wedge, bolt, nut and cotterpin.

2 surface finishes available:

- Model OWS B: blue painted.
- Model OWS BGAL: Hot dipped galvanized.

Model OWS 0.25 and OWS 0.5 only standard available in hot dipped galvanized
... [Read more](#)

Material: Quenched and tempered cast steel.

Marking: Size, wire rope diameter and batch or serial number.

Temperature range: -40°C to + 110°C - Use at higher temperatures possible with reduction of WLL.

Finish: Blue painting or hot dipped galvanized.

Note: The efficiency of a 6 and 8 strand wire rope/wedge socket connection is 80% of the minimum breaking load of the wire but limited to the minimum breaking load of the socket (MBL).

Open Wedge Socket OWS B with Bolt

Blueprint

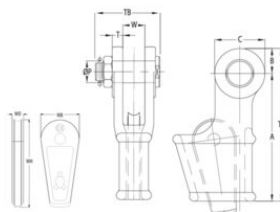

Technical data

Part code	Rope Ø range mm	MBL ton	Finish	A mm	B mm	C mm	øP mm	T mm	TLmm mm	TBmm mm	Wmm mm	WH mm mm	WB mm mm	WD mm mm	Weight kg
121500800212	7-8	8	Galvanized	110	18	36	16	9	128	62	18	70	35	9	0.8
121501000212	9-10	12	Galvanized	145	23	46	21	11	168	75	21	74	36	12	1.7
121501300212	11-13	20	Galvanized	157	29	57	25	12	185	80	25	115	48	14	2.1
121501300215	11-13	20	Painted	157	29	57	25	12	185	80	25	115	48	14	2.1
121501600212	14-16	25	Galvanized	190	35	70	30	15	225	96	31	135	57	18	4
121501600215	14-16	25	Painted	190	35	70	30	15	225	96	31	135	57	18	4
121501900212	18-19	40	Galvanized	210	40	80	35	16	250	107	38	160	70	21	7
121501900215	18-19	40	Painted	210	40	80	35	16	250	107	38	160	70	21	7
121502200215	20-22	55	Painted	252	48	95	41	18	300	123	44	187	77	24	10
121502200212	20-22	55	Galvanized	252	48	95	41	18	300	123	44	187	77	24	10
121502600215	23-26	75	Painted	298	55	110	51	22	353	141	51	212	83	28	15
121502600212	23-26	75	Galvanized	298	55	110	51	22	353	141	51	212	83	28	15
121502900215	27-29	90	Painted	322	65	130	57	25	387	160	57	232	91	30	21
121502900212	27-29	90	Galvanized	322	65	130	57	25	387	160	57	232	91	30	21
121503200215	30-32	110	Painted	350	73	146	63	28	423	165	63	266	108	33	31
121503200212	30-32	110	Galvanized	350	73	146	63	28	423	165	63	266	108	33	31
121503600215	34-36	125	Painted	400	74	148	64	28	474	185	70	298	116	35	37
121503600212	34-36	125	Galvanized	400	74	148	64	28	474	185	70	298	116	35	37
121503900212	37-39	150	Galvanized	450	80	142	70	30	530	210	77	338	130	38	51
121503900215	37-39	150	Painted	450	80	142	70	30	530	210	77	338	130	38	51
121504200212	40-42	170	Galvanized	500	87	160	76	33	587	209	76	373	140	41	64
121504200215	40-42	170	Painted	500	87	160	76	33	587	209	76	373	140	41	64

Open Wedge Socket OWS B with Bolt

Technical data

Part code	Rope Ø range mm	MBL ton	Finish	A mm	B mm	C mm	øP mm mm	T mm	TLmm mm	TBmm mm	Wmm mm	WH mm mm	WB mm mm	WD mm mm	Weight kg
121504800215	43-48	225	Painted	550	100	186	89	39	650	237	89	408	146	48	96
121504800212	43-48	225	Galvanized	550	100	186	89	39	650	237	89	408	146	48	96
121505200215	49-52	280	Painted	637	105	205	95	46	740	263	101	450	160	53	130
121505200212	49-52	280	Galvanized	637	105	205	95	46	740	263	101	450	160	53	130
121505800215	54-58	360	Painted	660	125	250	108	54	785	298	114	470	168	58	180
121505800212	54-58	360	Galvanized	660	125	250	108	54	785	298	114	470	168	58	180
121506800215	60-68	425	Painted	835	135	270	121	60	970	330	127	500	176	65	275
121506800212	60-68	425	Galvanized	835	135	270	121	60	970	330	127	500	176	65	275
121507600215	72-76	460	Painted	1,000	150	300	133	76	1,150	380	146	550	244	70	440
121507600212	72-76	460	Galvanized	1,000	150	300	133	76	1,150	380	146	550	244	70	440
121508600215	81-86	625	Painted	1,160	150	300	140	79	1,310	397	159	670	260	80	510
121508600212	81-86	625	Galvanized	1,160	150	300	140	79	1,310	397	159	670	260	80	510