

Eye Bolt Green Pin® AL

Product information



The Green Pin® Lifting Eye is a grade 8 lifting eye. Our extensive range of alloy steel lifting eyes, incorporates 22 different ISO metric threads as standard. Other special threads such as UNC, are also available. The WLL for lifting points are valid for in-line lifting only, but can be side loaded with reduction of the WLL. The longer thread length of the AL makes a through-hole mounting with a nut and washer on the other side possible. The nut on the bolt should at least be class 8, but class 10 or 12 is recommended. WLL and CE are stamped on the body. Safety factor is 5:1. The thread length of the lifting eye should be adapted to the material of the load. The Green Pin® Lifting Eye is available in a range with a working load limit from 0.2 t. up to 36 t.

Certification on request: 2.1, 2.2, 3.1, MTCa, MPIb

[... Read more](#)

Material: Alloy steel, quenched and tempered

Marking: CE-marked

Temperature range: -40°C up to +200°C

Finish: Painted white

Safety factor: 5:1

Grade: 8

Eye Bolt Green Pin® AL

Blueprint

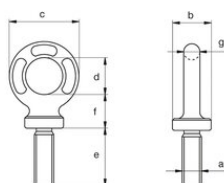

Technical data

Part code	Code	WLL ton	Thread mm	a mm	b mm mm	c mm	d mm mm	e mm mm	f mm mm	g mm mm	Weight kg
421100020290	GPAL06	0.2	M6	6	20	34	20	20	17	7	0.05
421100040290	GPAL08	0.4	M8	8	20	34	20	24	17	7	0.07
421100070290	GPAL10	0.7	M10	10	20	38	22	30	19	8	0.08
421100100290	GPAL12	1	M12	12	25	47	26	36	23	10	0.14
421100120290	GPAL14	1.2	M14	14	30	57	29	40	28	14	0.25
421100150290	GPAL16	1.5	M16	16	36	65	35	53	30	14	0.39
421100200290	GPAL18	2	M18	18	36	65	35	53	30	14	0.38
421100250290	GPAL20	2.5	M20	20	40	73	39	58	34	16	0.58
421100300290	GPAL22	3	M22	22	42	82	44	64	38	19	1.01
421100400290	GPAL24	4	M24	24	55	95	54	84	40	20	1.12
421100500290	GPAL27	5	M27	27	55	95	54	84	40	20	1.18
421100600290	GPAL30	6	M30	30	60	108	59	99	49	24	1.84
421100700290	GPAL33	7	M33	33	60	108	59	99	49	24	2.01
421100800290	GPAL36	8	M36	36	65	118	67	117	45	25	2.44
421100900290	GPAL39	9	M39	39	65	118	67	117	45	25	2.62
421101000290	GPAL42	10	M42	42	70	139	79	135	56	31	5.41
421101500290	GPAL45	15	M45	45	70	139	79	135	56	31	4.16
421101800290	GPAL48	18	M48	48	95	181	97	150	68	42	8.22
421102000290	GPAL52	20	M52	52	95	181	97	150	68	42	8.55
421102500290	GPAL56	25	M56	56	95	181	97	150	68	42	8.85
421103000290	GPAL60	30	M60	60	95	181	97	150	68	42	9.16
421103600290	GPAL64	36	M64	64	95	181	97	150	68	42	9.55

Eye Bolt Green Pin® AL
